

◎ 19金屬按鈕開關 Metal Push Button Switch

產品外觀

技術參數

外形尺寸



MP19S/F10

安裝尺寸Diameter: Φ 19mm
 開關額定值Switch Rating: 5A/250VAC
 開關組合
 Contact Configuration: 1NO
 操作類型Operation Type: 自復型Momentary
 頭部形狀The Front Shape: 平面 Flat
 外殼材料
 The Crust Material: 不銹鋼Stainless steel
 銅鍍鉻Copper plating
 防護等級IP Degree: IP67, IK10

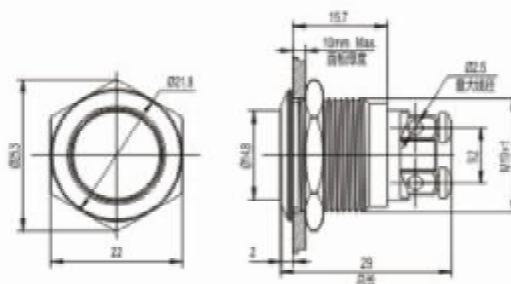

MP19S/B10

安裝尺寸Diameter: Φ 19mm
 開關額定值Switch Rating: 5A/250VAC
 開關組合
 Contact Configuration: 1NO
 操作類型Operation Type: 自復型Momentary
 頭部形狀The Front Shape: 球面 Ball
 外殼材料
 The Crust Material: 不銹鋼Stainless steel
 銅鍍鉻Copper plating
 防護等級IP Degree: IP67, IK10

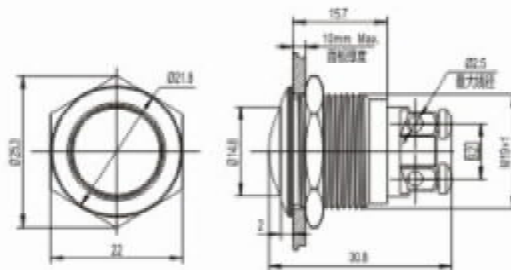

MP19S/H10

安裝尺寸Diameter: Φ 19mm
 開關額定值Switch Rating: 5A/250VAC
 開關組合
 Contact Configuration: 1NO
 操作類型Operation Type: 自復型Momentary
 頭部形狀The Front Shape: 高頭 High
 外殼材料
 The Crust Material: 不銹鋼Stainless steel
 銅鍍鉻Copper plating
 防護等級IP Degree: IP67, IK10

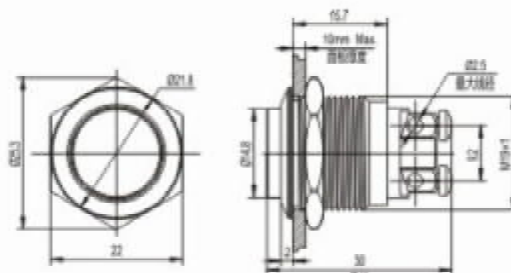

產品規格	Specification	MP19S/F10	MP19S/B10	MP19S/H10	
尾部配置	Terminal Type	接線柱Wiring terminal	接線柱Wiring terminal	接線柱Wiring terminal	
開關結構	Switching	NO.1	NO.1	NO.1	
開關規格	Max. Switch Rating	5A/250VAC	5A/250VAC	5A/250VAC	
接觸電阻	Contact Resistance	$\leq 50m\Omega$	$\leq 50m\Omega$	$\leq 50m\Omega$	
絕緣電阻	Insulation Resistance	$\geq 1000M\Omega$	$\geq 1000M\Omega$	$\geq 1000M\Omega$	
絕緣強度	Dielectric Intensity	2000VAC	2000VAC	2000VAC	
環境溫度	Operating Temp	-20°C~+55°C	-20°C~+55°C	-20°C~+55°C	
機械壽命	Mechanical Life	100萬次以上 1,000,000 cycles	100萬次以上 1,000,000 cycles	100萬次以上 1,000,000 cycles	
電氣壽命	Electrical Life	20萬次以上 200,000 cycles	20萬次以上 200,000 cycles	20萬次以上 200,000 cycles	
面板厚度	Panel Thickness	1~10mm	1~10mm	1~10mm	
螺母扭矩	Torque	4~15Nm	4~15Nm	4~15Nm	
操作壓力	Operation Pressure	約4N About 4N	約4N About 4N	約4N About 4N	
操作行程	Operation Travel	約1.8mm About 1.8mm	約1.8mm About 1.8mm	約1.8mm About 1.8mm	
防護等級	IP Degree	IP67, IK10	IP67, IK10	IP67, IK10	
材料 Material	觸點	Contact	銀鍍金Silver Plated Gold	銀鍍金Silver Plated Gold	銀鍍金Silver Plated Gold
	按鈕	Button	不銹鋼Stainless steel 銅鍍鉻Copper plating	不銹鋼Stainless steel 銅鍍鉻Copper plating	不銹鋼Stainless steel 銅鍍鉻Copper plating
	外殼	Body	不銹鋼Stainless steel 銅鍍鉻Copper plating	不銹鋼Stainless steel 銅鍍鉻Copper plating	不銹鋼Stainless steel 銅鍍鉻Copper plating
	底座	Base	聚碳酸酯PC	聚碳酸酯PC	聚碳酸酯PC
	RohS	RohS	可定制Made to order	可定制Made to order	可定制Made to order
帶燈 部分 參數 LED Spec.	帶燈類型	Lamp type			
	額定電壓	Rated Voltage(Ue)			
	燈珠顏色	Color			
	燈珠壽命	Life			

Φ19金屬按鈕開關 Metal Push Button Switch

產品外觀

技術參數

外形尺寸



安裝尺寸Diameter: Φ19mm
 開關額定值Switch Rating: 5A/250VAC
 開關組合
 Contact Configuration: 1NO
 操作類型Operation Type: 自復型Momentary
 頭部形狀The Front Shape: 平面 Flat
 外殼材料
 The Crust Material: 不銹鋼Stainless steel
 防護等級IP Degree: IP68, IK10

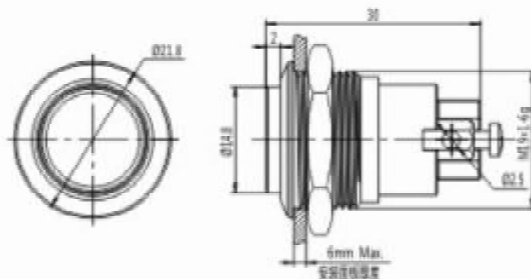

安裝尺寸Diameter: Φ19mm
 開關額定值Switch Rating: 5A/250VAC
 開關組合
 Contact Configuration: 1NO
 操作類型Operation Type: 自復型Momentary
 頭部形狀The Front Shape: 球面 Ball
 外殼材料
 The Crust Material: 不銹鋼Stainless steel
 防護等級IP Degree: IP68, IK10

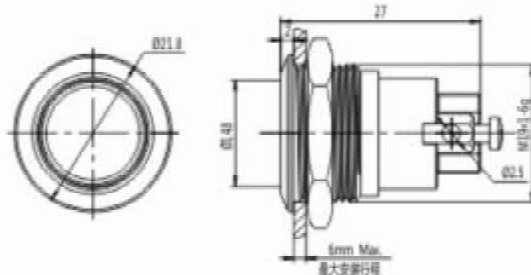

安裝尺寸Diameter: Φ19mm
 開關額定值Switch Rating: 5A/250VAC
 開關組合
 Contact Configuration: 1NO
 操作類型Operation Type: 自復型Momentary
 頭部形狀The Front Shape: 高頭 High
 外殼材料
 The Crust Material: 不銹鋼Stainless steel
 防護等級IP Degree: IP68, IK10

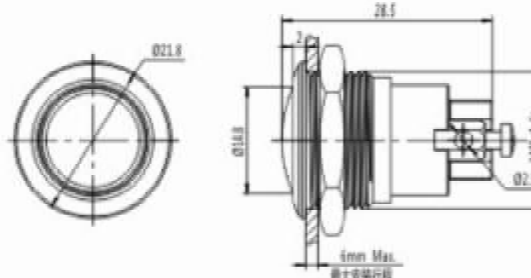

產品規格	Specification	MP19S/F20	MP19S/B20	MP19S/H20
尾部配置	Terminal Type	接線柱Wiring terminal	接線柱Wiring terminal	接線柱Wiring terminal
開關結構	Switching	NO.1	NO.1	NO.1
開關規格	Max. Switch Rating	5A/250VAC	5A/250VAC	5A/250VAC
接觸電阻	Contact Resistance	≤50mΩ	≤50mΩ	≤50mΩ
絕緣電阻	Insulation Resistance	≥1000MΩ	≥1000MΩ	≥1000MΩ
絕緣強度	Dielectric Intensity	2000VAC	2000VAC	2000VAC
環境溫度	Operating Temp	-20°C~+55°C	-20°C~+55°C	-20°C~+55°C
機械壽命	Mechanical Life	100萬次以上 1,000,000 cycles	100萬次以上 1,000,000 cycles	100萬次以上 1,000,000 cycles
電氣壽命	Electrical Life	20萬次以上200,000 cycles	20萬次以上200,000 cycles	20萬次以上200,000 cycles
面板厚度	Panel Thickness	1~10mm	1~10mm	1~10mm
螺母扭矩	Torque	4~15Nm	4~15Nm	4~15Nm
操作壓力	Operation Pressure	約4N About 4N	約4N About 4N	約4N About 4N
操作行程	Operation Travel	約1.8mm About 1.8mm	約1.8mm About 1.8mm	約1.8mm About 1.8mm
防護等級	IP Degree	IP68, IK10	IP68, IK10	IP68, IK10
Material	觸點	鍍銀金Silver Plated Gold	鍍銀金Silver Plated Gold	鍍銀金Silver Plated Gold
	按鈕	不銹鋼Stainless steel	不銹鋼Stainless steel	不銹鋼Stainless steel
	外殼	不銹鋼Stainless steel	不銹鋼Stainless steel	不銹鋼Stainless steel
	基座	聚碳酸酯PC	聚碳酸酯PC	聚碳酸酯PC
RohS	RohS	可定制Made to order	可定制Made to order	可定制Made to order
帶燈部分參數 Spec.	帶燈類型			
	額定電壓			
	燈珠顏色			
	燈珠壽命			

Φ19金屬按鈕開關 Metal Push Button Switch

產品外觀

技術參數

外形尺寸



MP19S/FJ

安裝尺寸Diameter: Φ19mm
 開關額定值Switch Rating: 5A/250VAC
 開關組合
 Contact Configuration: 1NO
 操作類型Operation Type: 自復型Momentary
 頭部形狀The Front Shape: 平面 Flat
 外殼材料
 The Crust Material: 不銹鋼Stainless steel
 銅鍍鎳Copper plating
 防護等級IP Degree: IP67, IK10

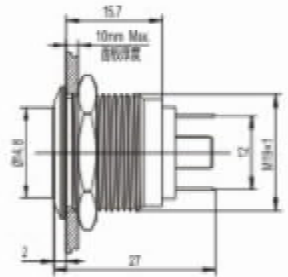
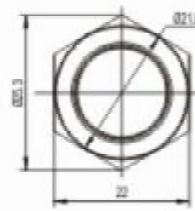

MP19S/BJ

安裝尺寸Diameter: Φ19mm
 開關額定值Switch Rating: 5A/250VAC
 開關組合
 Contact Configuration: 1NO
 操作類型Operation Type: 自復型Momentary
 頭部形狀The Front Shape: 球面 Ball
 外殼材料
 The Crust Material: 不銹鋼Stainless steel
 銅鍍鎳Copper plating
 防護等級IP Degree: IP67, IK10

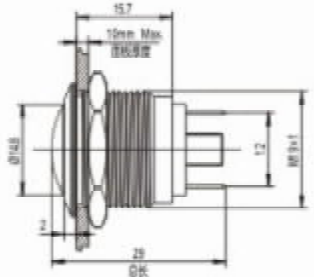
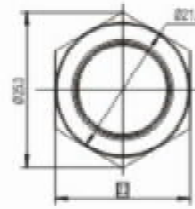

MP19S/HJ

安裝尺寸Diameter: Φ19mm
 開關額定值Switch Rating: 5A/250VAC
 開關組合
 Contact Configuration: 1NO
 操作類型Operation Type: 自復型Momentary
 頭部形狀The Front Shape: 高頂 High
 外殼材料
 The Crust Material: 不銹鋼Stainless steel
 銅鍍鎳Copper plating
 防護等級IP Degree: IP67, IK10

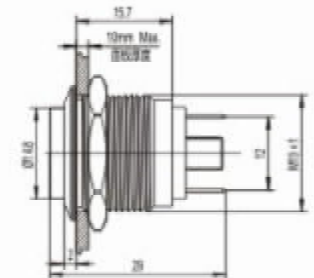
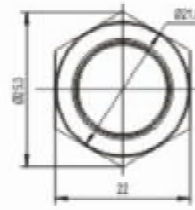

產品規格	Specification	MS19P/FJ	MS19P/BJ	MP19S/HJ
尾部配置	Terminal Type	接線插片Pin Terminal(2×0.5mm)	接線插片Pin Terminal(2×0.5mm)	接線插片Pin Terminal(2×0.5mm)
開關結構	Switching	NO.1	NO.1	NO.1
開關規格	Max. Switch Rating	5A/250VAC	5A/250VAC	5A/250VAC
接觸電阻	Contact Resistance	≤50mΩ	≤50mΩ	≤50mΩ
絕緣電阻	Insulation Resistance	≥1000MΩ	≥1000MΩ	≥1000MΩ
絕緣強度	Dielectric Intensity	2000VAC	2000VAC	2000VAC
環境溫度	Operating Temp	-20°C~+55°C	-20°C~+55°C	-20°C~+55°C
機械壽命	Mechanical Life	100萬次以上 1,000,000 cycles	100萬次以上 1,000,000 cycles	100萬次以上 1,000,000 cycles
電氣壽命	Electrical Life	20萬次以上 200,000 cycles	20萬次以上 200,000 cycles	20萬次以上 200,000 cycles
面板厚度	Panel Thickness	1~10mm	1~10mm	1~10mm
螺母扭矩	Torque	4~15Nm	4~15Nm	4~15Nm
操作壓力	Operation Pressure	約4N About 4N	約4N About 4N	約4N About 4N
操作行程	Operation Travel	約1.8mm About 1.8mm	約1.8mm About 1.8mm	約1.8mm About 1.8mm
防護等級	IP Degree	IP67,IK10	IP67,IK10	IP67,IK10
材料 Material	觸點	Contact	銀鍍金Silver Plated Gold	銀鍍金Silver Plated Gold
	按鈕	Button	不銹鋼Stainless steel 銅鍍鎳Copper plating	不銹鋼Stainless steel 銅鍍鎳Copper plating
	外殼	Body	不銹鋼Stainless steel 銅鍍鎳Copper plating	不銹鋼Stainless steel 銅鍍鎳Copper plating
	基底	Base	聚碳酸酯PC	聚碳酸酯PC
	RohS	RohS	可定制Made to order	可定制Made to order
帶燈 部分 參數 LED Spec	帶燈類型	Lamp type		
	額定電壓	Rated Voltage(Uo)		
	燈珠顏色	Color		
	燈珠壽命	Life		

Φ19金屬按鈕開關 Metal Push Button Switch

產品外觀

技術參數

外形尺寸



MP019S/F11

安裝尺寸Diameter: Φ19mm
 開關額定值Switch Rating: 5A/250VAC
 開關組合
 Contact Configuration: 1NO 1NC/2NO 2NC
 操作類型Operation Type: 自復型Momentary
 自鎖型Maintained(Z)
 頭部形狀The Front Shape: 平頭 Flat
 外殼材料
 The Crust Material: 不銹鋼Stainless steel
 防護等級IP Degree: IP67, IK10

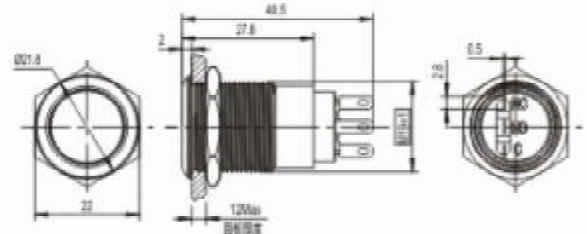

MP019S/B11

安裝尺寸Diameter: Φ19mm
 開關額定值Switch Rating: 5A/250VAC
 開關組合
 Contact Configuration: 1NO 1NC/2NO 2NC
 操作類型Operation Type: 自復型Momentary
 自鎖型Maintained(Z)
 頭部形狀The Front Shape: 球面 Ball
 外殼材料
 The Crust Material: 不銹鋼Stainless steel
 防護等級IP Degree: IP67, IK10

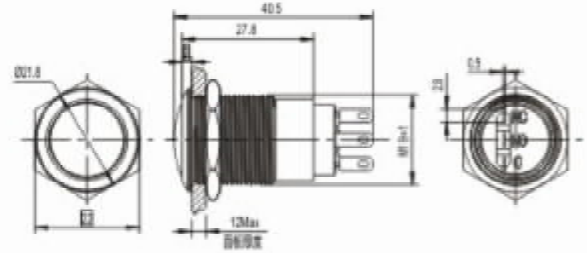

MP019S/H22

安裝尺寸Diameter: Φ19mm
 開關額定值Switch Rating: 5A/250VAC
 開關組合
 Contact Configuration: 1NO 1NC/2NO 2NC
 操作類型Operation Type: 自復型Momentary
 自鎖型Maintained(Z)
 頭部形狀The Front Shape: 高頂 High
 外殼材料
 The Crust Material: 不銹鋼Stainless steel
 防護等級IP Degree: IP67, IK10

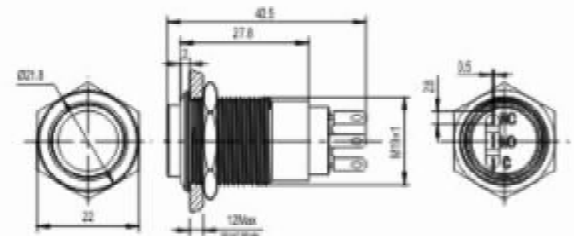

產品規格	Specification	MP019S/F11	MP019S/B11	MP019S/H22	
尾部配置	Terminal Type	接線插片Pin Terminal(2.8x0.5mm)	接線插片Pin Terminal(2.8x0.5mm)	接線插片Pin Terminal(2.8x0.5mm)	
開關結構	Switching	NO.1	NO.1	NO.1	
開關規格	Max. Switch Rating	5A/250VAC	5A/250VAC	5A/250VAC	
接觸電阻	Contact Resistance	≤50mΩ	≤50mΩ	≤50mΩ	
絕緣電阻	Insulation Resistance	≥1000MΩ	≥1000MΩ	≥1000MΩ	
絕緣強度	Dielectric Intensity	2000VAC	2000VAC	2000VAC	
環境溫度	Operating Temp	-20°C~+55°C	-20°C~+55°C	-20°C~+55°C	
機械壽命	Mechanical Life	100萬次以上 1,000,000 cycles	100萬次以上 1,000,000 cycles	100萬次以上 1,000,000 cycles	
電氣壽命	Electrical Life	5萬次以上50,000 cycles	5萬次以上50,000 cycles	5萬次以上50,000 cycles	
面板厚度	Panel Thickness	1~10mm	1~10mm	1~10mm	
螺母扭矩	Torque	5~14Nm	5~14Nm	5~14Nm	
操作壓力	Operation Pressure	3~5N	3~5N	3~5N	
操作行程	Operation Travel	約3.1mm About3.1mm	約3.1mm About3.1mm	約3.1mm About3.1mm	
防護等級	IP Degree	IP67, IK10	IP67, IK10	IP67, IK10	
材料 Material	觸點	Contact	銀鍍金Silver Plated Gold	銀鍍金Silver Plated Gold	銀鍍金Silver Plated Gold
	按鍵	Button	不銹鋼Stainless steel 銅鍍鎳Copper plating	不銹鋼Stainless steel 銅鍍鎳Copper plating	不銹鋼Stainless steel 銅鍍鎳Copper plating
	外殼	Body	不銹鋼Stainless steel 銅鍍鎳Copper plating	不銹鋼Stainless steel 銅鍍鎳Copper plating	不銹鋼Stainless steel 銅鍍鎳Copper plating
	基座	Base	聚碳酸酯PC	聚碳酸酯PC	聚碳酸酯PC
	RohS	RohS	可定制Made to order	可定制Made to order	可定制Made to order
帶燈 部分參數 LED Spec.	帶燈類型	Lamp type			
	額定電壓	Rated Voltage(Ue)			
	燈珠顏色	Color			
	燈珠壽命	Life			

Φ19金屬按鈕開關 Metal Push Button Switch

產品外觀

技術參數

外形尺寸



MP019S/F11-Δ▲EDY

安裝尺寸Diameter: Φ19mm
 燈珠顏色Color:
 開關額定值Switch Rating: 5A/250VAC
 開關組合Contact Configuration: 1NO 1NC/2NO 2NC
 操作類型Operation Type: 自鎖型Momentary
 自鎖型Maintained
 頭部形狀The Front Shape: 平面 Flat
 帶燈方式Lamp type: 電源標Power symbol illuminated(LED)
 外殼材料The Crust Material: 不銹鋼Stainless steel
 防護等級IP Degree: IP67, IK10

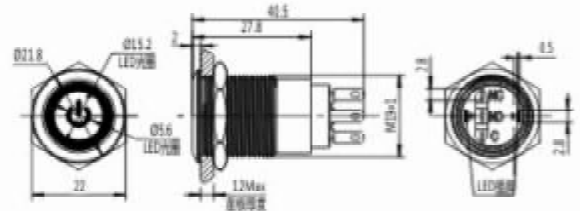

MP019S/K11-2/3

安裝尺寸Diameter: Φ19mm
 開關額定值Switch Rating: 5A/250VAC
 開關組合Contact Configuration: 1NO 1NC/2NO 2NC
 操作位置Operation Type: 2位置保持式 2 Position
 3位置保持式 3 Position
 頭部形狀The Front Shape: 旋鈕selector
 帶燈方式Light way: 箭頭指示Arrow
 外殼材料The Crust Material: 不銹鋼Stainless steel
 防護等級IP Degree: IP67, IK10

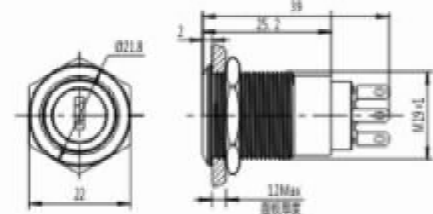

MP019B/TS11

安裝尺寸Diameter: Φ19mm
 電氣參數Switch Rating: 5A/250VAC
 開關組合Contact Configuration: 1NO 1NC/2NO 2NC
 操作類型Operation Type: 推鎖旋放式Push-Lock Turn-reset
 頭部形狀The Front Shape: 球面 Ball
 帶燈方式Light way: 箭頭指示Arrow
 外殼材料The Crust Material: 不銹鋼Stainless steel
 防護等級IP Degree: IP65, IK10

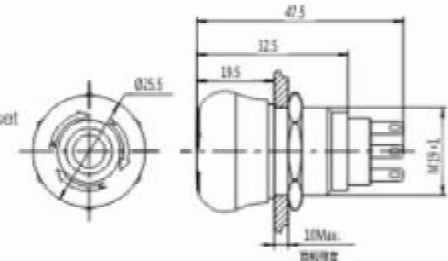

MP019H/TS11

安裝尺寸Diameter: Φ19mm
 電氣參數Switch Rating: 5A/250VAC
 開關組合Contact Configuration: 1NO 1NC/2NO 2NC
 操作類型Operation Type: 推鎖旋放式Push-Lock Turn-reset
 頭部形狀The Front Shape: 球面 Ball
 帶燈方式Light way: 箭頭指示Arrow
 外殼材料The Crust Material: 不銹鋼Stainless steel
 防護等級IP Degree: IP65, IK10

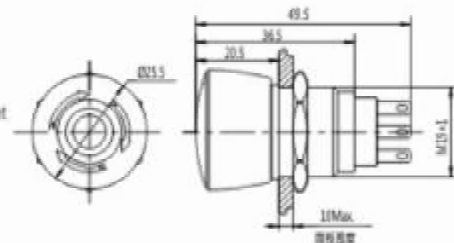

產品規格	Specification	MP019S/F11-Δ▲EDY	MP019S/K11-2/3	MP019B/TS11	MP019H/TS11	
尾部配置	Terminal Type	接線插片Pin Terminal(2.8x0.5mm)	接線插片Pin Terminal(2.8x0.5mm)	接線插片Pin Terminal(2.8x0.5mm)	接線插片Pin Terminal(2.8x0.5mm)	
開關結構	Switching	NO,3	NO,3	NO,3	NO,3	
開關規格	Max. Switch Rating	5A/250VAC	5A/250VAC	5A/250VAC	5A/250VAC	
接觸電阻	Contact Resistance	≤50mΩ	≤50mΩ	≤50mΩ	≤50mΩ	
絕緣電阻	Insulation Resistance	>1000MΩ	>1000MΩ	>1000MΩ	>1000MΩ	
絕緣強度	Dielectric Intensity	2000VAC	2000VAC	2000VAC	2000VAC	
環境溫度	Operating Temp	-20°C~+55°C	-20°C~+55°C	-20°C~+55°C	-20°C~+55°C	
機械壽命	Mechanical Life	100萬次以上 1,000,000 cycles	100萬次以上 1,000,000 cycles	20萬次以上 200,000 cycles	20萬次以上 200,000 cycles	
電氣壽命	Electrical Life	5萬次以上 50,000 cycles	5萬次以上 50,000 cycles	5萬次以上 50,000 cycles	5萬次以上 50,000 cycles	
面板厚度	Panel Thickness	1-10mm	1-10mm	1-6mm	1-6mm	
螺母扭矩	Torque	5-14Nm	5-14Nm	5-14Nm	5-14Nm	
操作壓力	Operation Pressure	3-5N	3-5N	5.8-8.3N	5.8-8.3N	
操作行程	Operation Travel	約3.1mm About3.1mm	約3.1mm About3.1mm	約3.1mm About3.1mm	約3.1mm About3.1mm	
防護等級	IP Degree	IP67,IK10	IP67,IK10	IP67,IK10	IP67,IK10	
材料 Material	觸點	Contact	銀鍍金Silver Plated Gold	銀鍍金Silver Plated Gold	銀鍍金Silver Plated Gold	銀鍍金Silver Plated Gold
	按鈕	Button	不銹鋼Stainless steel 銅鍍鎳Copper plating	不銹鋼Stainless steel 銅鍍鎳Copper plating	不銹鋼Stainless steel 銅鍍鎳Copper plating	不銹鋼Stainless steel 銅鍍鎳Copper plating
	外殼	Body	不銹鋼Stainless steel 銅鍍鎳Copper plating	不銹鋼Stainless steel 銅鍍鎳Copper plating	不銹鋼Stainless steel 銅鍍鎳Copper plating	不銹鋼Stainless steel 銅鍍鎳Copper plating
	底座	Base	聚碳酸酯PC	聚碳酸酯PC	聚碳酸酯PC	聚碳酸酯PC
	RohS	Rohs	可定制Made to order	可定制Made to order	可定制Made to order	可定制Made to order
帶燈部分參數 LED Spec.	帶燈類型	Lamp type	環形帶燈Ring illuminated(LED)			
	額定電壓	Rated Voltage(Ue)	6V/12V/24V/110V/220V			
	燈珠顏色	Color				
	燈珠壽命	Life	40000小時			

Φ19金屬按鈕開關 Metal Push Button Switch

產品外觀

技術參數

外形尺寸



安裝尺寸Diameter: Φ19mm
 燈珠顏色Color:
 開關額定值Switch Rating: 5A/250VAC
 開關組合Contact Configuration: 1NO1NC/2NO2NC
 操作類型Operation Type: 自復型Momentary
 自鎖型Maintained(Z)
 頭部形狀The Front Shape: 平面 Flat
 帶燈方式Lamp type: 環形帶燈Ring Illuminated(LED)
 外殼材料The Crust Material: 不銹鋼Stainless steel
 銅鍍層Copper plating
 防護等級IP Degree: IP67, IK10

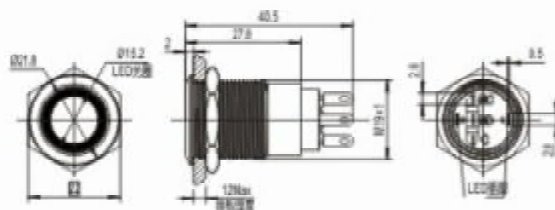

安裝尺寸Diameter: Φ19mm
 燈珠顏色Color:
 開關額定值Switch Rating: 5A/250VAC
 開關組合Contact Configuration: 1NO1NC/2NO2NC
 操作類型Operation Type: 自復型Momentary
 自鎖型Maintained(Z)
 頭部形狀The Front Shape: 平面 Flat
 帶燈方式Lamp type: 單點帶燈Dot Illuminated(LED)
 外殼材料The Crust Material: 不銹鋼Stainless steel
 防護等級IP Degree: IP67, IK10

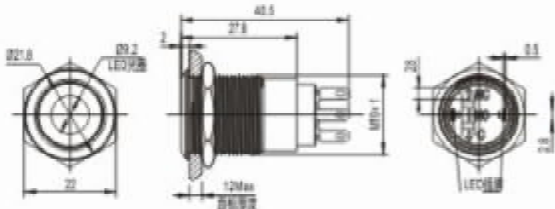

安裝尺寸Diameter: Φ19mm
 燈珠顏色Color:
 開關額定值Switch Rating: 5A/250VAC
 開關組合Contact Configuration: 1NO1NC/2NO2NC
 操作類型Operation Type: 自復型Momentary
 自鎖型Maintained(Z)
 頭部形狀The Front Shape: 球面 Ball
 帶燈方式Lamp type: 環形帶燈Ring Illuminated(LED)
 外殼材料The Crust Material: 不銹鋼Stainless steel
 銅鍍層Copper plating
 防護等級IP Degree: IP67, IK10

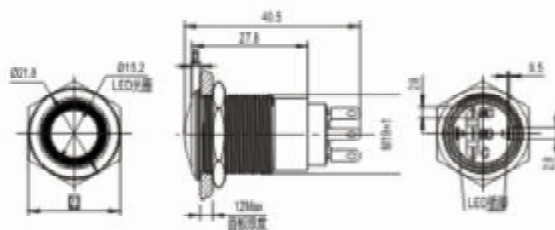

安裝尺寸Diameter: Φ19mm
 燈珠顏色Color:
 開關額定值Switch Rating: 5A/250VAC
 開關組合Contact Configuration: 1NO
 操作類型Operation Type: 自復型Momentary
 頭部形狀The Front Shape: 球面 Ball
 帶燈方式Lamp type: 環形帶燈Ring Illuminated(LED)
 外殼材料The Crust Material: 不銹鋼Stainless steel
 防護等級IP Degree: IP67, IK10

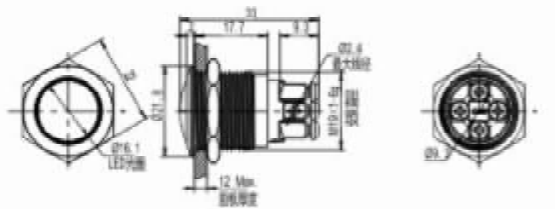

產品規格	Specification	MP019S/F11-Δ▲E	MP019S/F11-Δ▲D	MP019S/B11-Δ▲E	MP019S/B10-E	
尾部配置	Terminal Type	接線插片 Pin Terminal(2x0.5mm)	接線插片 Pin Terminal(2x0.5mm)	接線插片 Pin Terminal(2.8x0.5mm)	接線柱 Wiring terminal	
開關結構	Switching	NO.3	NO.3	NO.3	NO.1	
開關規格	Max. Switch Rating	5A/250VAC	3A/250VAC	5A/250VAC	5A/250VAC	
接觸電阻	Contact Resistance	≤50mΩ	≤50mΩ	≤50mΩ	≤50mΩ	
絕緣電阻	Insulation Resistance	≥1000MΩ	≥1000MΩ	≥1000MΩ	≥1000MΩ	
絕緣強度	Dielectric Intensity	2000VAC	2000VAC	2000VAC	2000VAC	
環境溫度	Operating Temp	-20℃~+55℃	-20℃~+55℃	-20℃~+55℃	-20℃~+55℃	
機械壽命	Mechanical Life	100萬次以上 1,000,000 cycles	100萬次以上 1,000,000 cycles	100萬次以上 1,000,000 cycles	100萬次以上 1,000,000 cycles	
電氣壽命	Electrical Life	5萬次以上 50,000 cycles	5萬次以上 50,000 cycles	5萬次以上 50,000 cycles	5萬次以上 50,000 cycles	
面板厚度	Panel Thickness	1~10mm	1~10mm	1~10mm	1~10mm	
螺母扭矩	Torque	5~14Nm	5~14Nm	5~14Nm	5~14Nm	
操作壓力	Operation Pressure	3~5N	3~5N	3~5N	3~5N	
操作行程	Operation Travel	約3.1mm About 3.1mm	約3.1mm About 3.1mm	約3.1mm About 3.1mm	約3.1mm About 3.1mm	
防護等級	IP Degree	IP67, IK10	IP67, IK10	IP67, IK10	IP67, IK10	
材料	觸點	Contact	銀鍍金 Silver Plated Gold	銀鍍金 Silver Plated Gold	銀鍍金 Silver Plated Gold	銀鍍金 Silver Plated Gold
	按鈕	Button	不銹鋼 Stainless steel 銅鍍層 Copper plating	不銹鋼 Stainless steel 銅鍍層 Copper plating	不銹鋼 Stainless steel 銅鍍層 Copper plating	不銹鋼 Stainless steel 銅鍍層 Copper plating
	外殼	Body	不銹鋼 Stainless steel 銅鍍層 Copper plating	不銹鋼 Stainless steel 銅鍍層 Copper plating	不銹鋼 Stainless steel 銅鍍層 Copper plating	不銹鋼 Stainless steel
	底座	Base	聚碳酸酯 PC	聚碳酸酯 PC	聚碳酸酯 PC	聚碳酸酯 PC
RohS	RohS	可定制 Made to order	可定制 Made to order	可定制 Made to order	可定制 Made to order	
帶燈部分參數 LED Spec	帶燈類型	Lamp type	環形帶燈 Ring Illuminated(LED)	單點帶燈 Dot illuminated(LED)	環形帶燈 Ring Illuminated(LED)	環形帶燈 Ring Illuminated(LED)
	額定電壓	Rated Voltage(Ue)	6V/12V/24V/110V/220V	6V/12V/24V/110V/220V	6V/12V/24V/110V/220V	6V/12V/24V/110V/220V
	燈珠顏色	Color				
	燈珠壽命	Life	40000小時	40000小時	40000小時	40000小時

