

4A Series

Sealed Sub-Miniature Rocker Switches



SPECIFICATIONS

CONTACT RATING: Dependent upon contact material.

MECHANICAL LIFE: 30,000 make-and-break cycles.

CONTACT RESISTANCE: 20mΩ max. initial @ 2-4VDC
100mA for both silver and gold plated contacts.

INSULATION RESISTANCE: 1,000MΩ min.

DIELECTRIC STRENGTH: 1,000 V RMS@sea level.

OPERATING TEMPERATURE: -30°C to 85°C.

MATERIALS

CASE & BUSHING: Glass filled nylon 6/6, flame retardant, heat stabilized (UL 94V-0)

ACTUATOR: Nylon, black std. Internal O-ring seal standard with all actuators.

SWITCH SUPPORT: Brass or steel, tin plated.

CONTACTS/TERMINALS: Silver or gold plated copper alloy. (See Page 79)

HOW TO ORDER

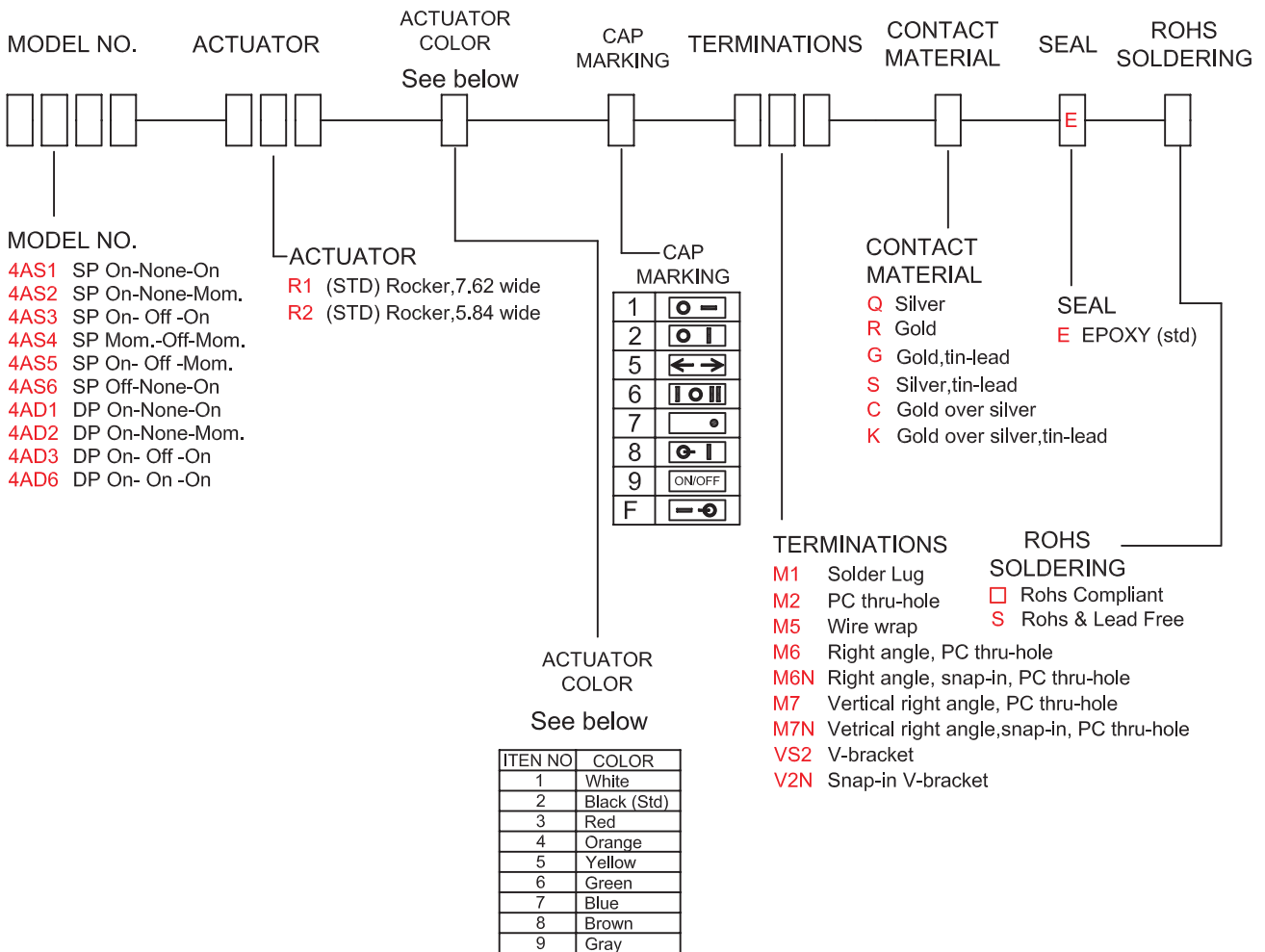

SWITCH FUNCTION

NO. POLES	UL/CSA MODEL NO.	MODEL NO.	SWITCH FUNCTION			CONNECTED TERMINALS / SCHEMATIC		
			POS.1	POS.2	POS.3	POS.1	POS.2	POS.3
SP	Q24A11	4AS1	ON	NONE	ON	2-3	N/A	2-1
	Q24A12	4AS2	ON	NONE	MOM			
	Q24A13	4AS3	ON	OFF	ON		OPEN	
	Q24A14	4AS4	MOM	OFF	MOM			
	Q24A15	4AS5	ON	OFF	MOM	OPEN	N/A	3-1
	Q24A16	4AS6	OFF	NONE	ON			
DP	Q24A21	4AD1	ON	NONE	ON	2-3,5-6	N/A	2-1,5-4
	Q24A22	4AD2	ON	NONE	MOM			
	Q24A23	4AD3	ON	OFF	ON		OPEN	
	Q24A26	4AD6	ON	ON	ON			

MOM=MOMENTARY

POLE OPTIONS

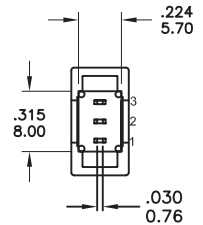
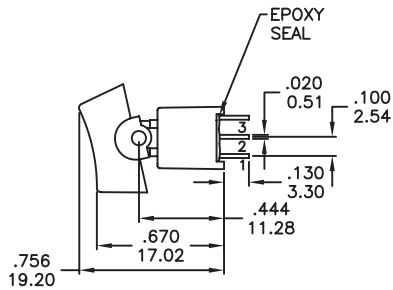
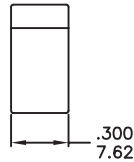

SPDT

Part No. Shown : 4AS1R12M2RE

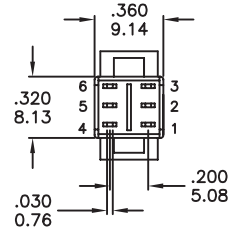
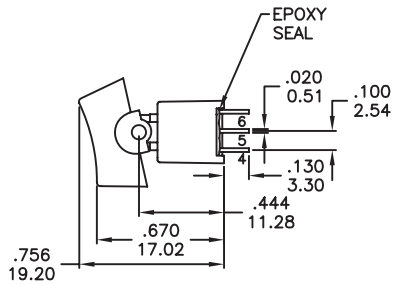
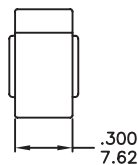

DPDT

Part No. Shown : 4AD1R12M2RE

4A Sealed Sub-Miniature Rocker Switches

ACTUATOR OPTIONS / PANEL MOUNT

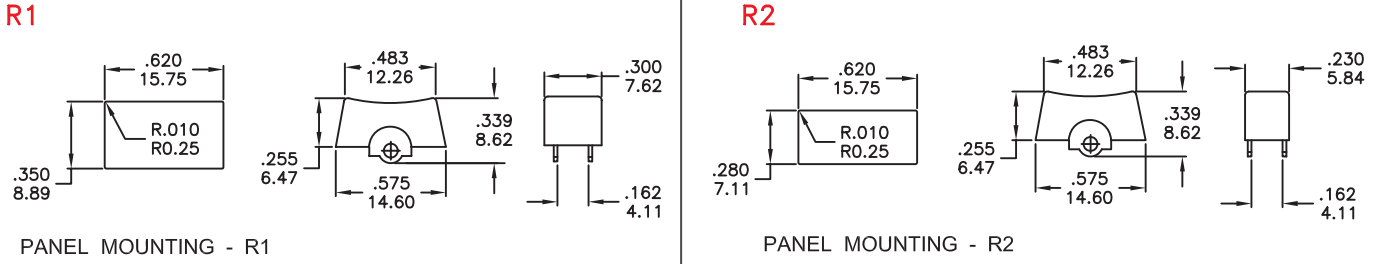

TERMINATION OPTIONS

M2 P.C THRU-HOLE

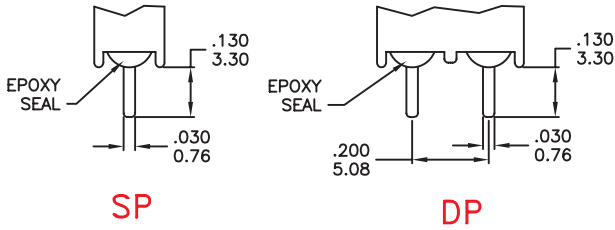

M5 WIRE WRAP

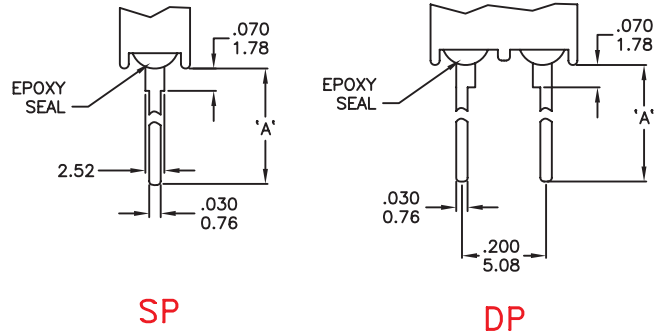

OTHER TERMINATION OPTIONS

M6	RIGHT ANGLE P.C. MOUNT
M7	RIGHT ANGLE P.C. MOUNT
VS2	VERTICAL BRACKET P.C. MOUNT
VS3	VERTICAL BRACKET P.C. MOUNT

OPTION CODE	DIM. 'A'
M5-1	.614(15.60)
M5-2	.236(6.00)

M6

P.C. MOUNTING

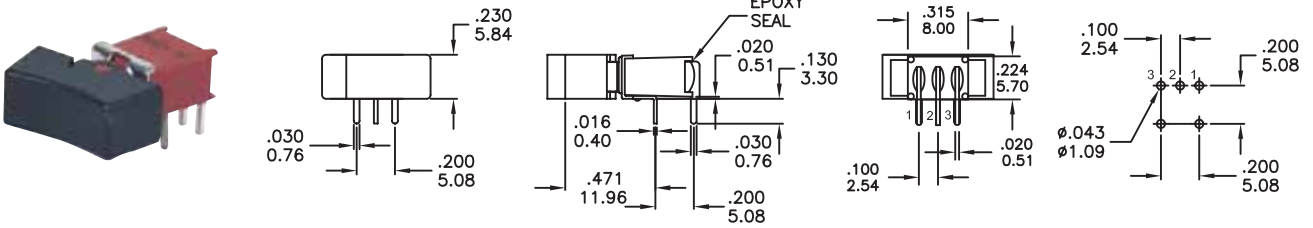

SPDT

Part No. Shown : 4AS1R22M6QE

M6

P.C. MOUNTING

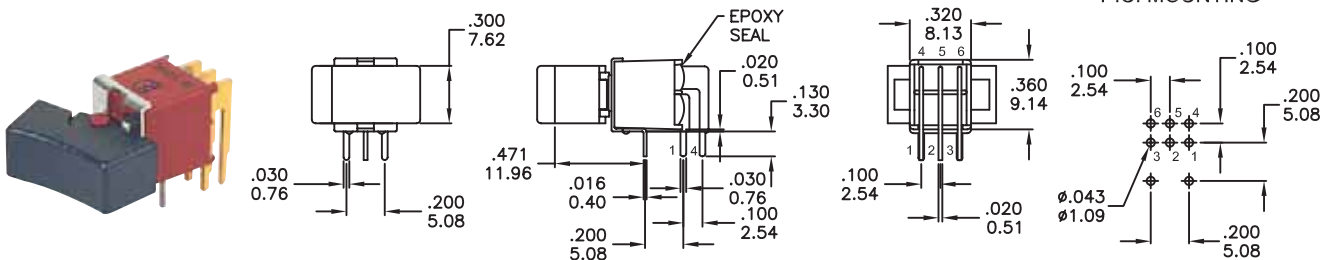

DPDT

Part No. Shown : 4AD1R12M6RE

4A Series

Sealed Sub-Miniature Rocker Switches

M7

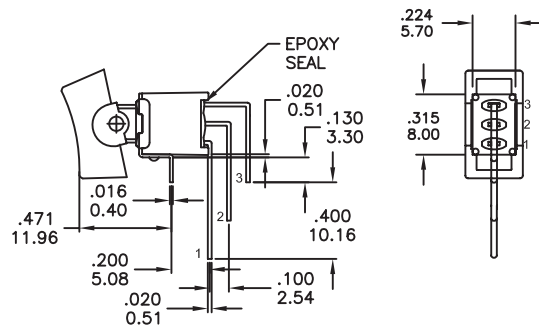
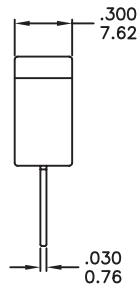

P.C. MOUNTING

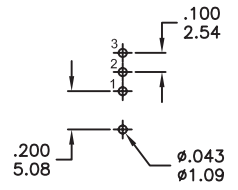

SPDT

Part No. Shown : 4AS1R12M7QE

M7

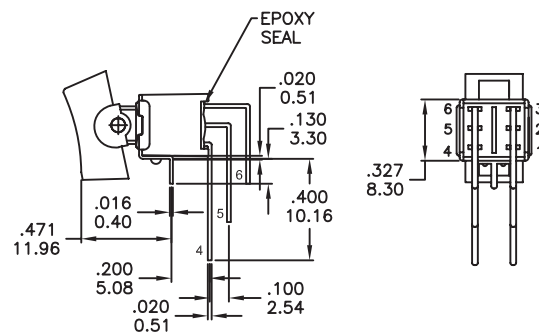
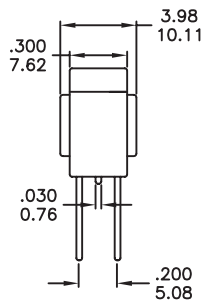

P.C. MOUNTING

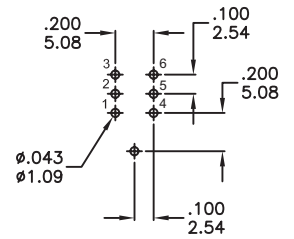

DPDT

Part No. Shown : 4AD1R12M7RE

VS2

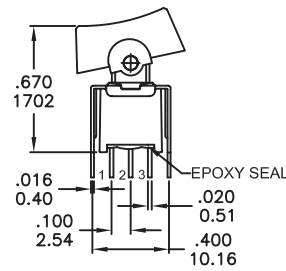
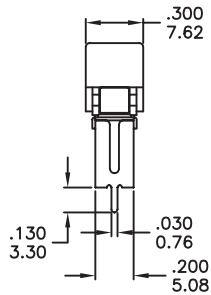

P.C. MOUNTING

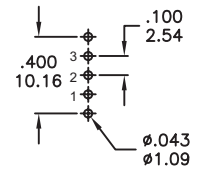

SPDT

Part No. Shown : 4AS1R12VS2RE

VS2

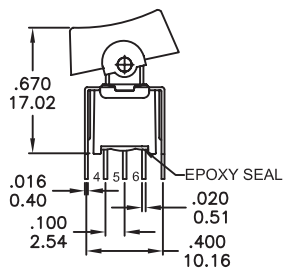
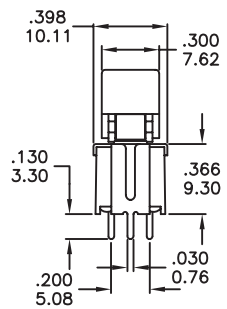

P.C. MOUNTING

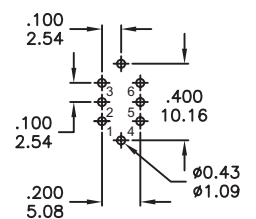

DPDT

Part No. Shown : 4AD1R12VS2RE

4A Sealed Sub-Miniature Rocker Switches

SNAP-IN TERMINATION OPTIONS

M6N



M7N

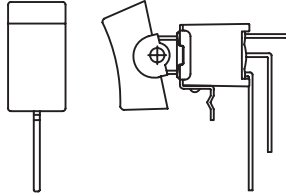

V2N

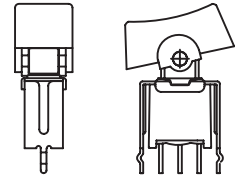

CONTACT MATERIAL OPTIONS

	CONTACT MATERIAL	TERMINATION RATING	RATINGS
Q	Silver	Q = Gold flash over silver	3 Amps with resistant load @ 120VAC or 28VDC 1 Amps with resistant load @ 250VAC
S		S = Gold flash over silver,pure - tin	
C	Gold over Silver	C = Gold over silver	
K		K = Gold over silver,pure - tin	
R	Gold	R = Gold	0.4 Volt-Amps(VA)max. @ 20V max. (AC or DC)
G		G = Gold,pure - tin	



IP 67
 ACCORDING TO
 EN 60529:1991+A1:2001
 IEC 60529:2001

SOLDERING PROCESSES

MANUAL SOLDERING : Use soldering iron of 30 watts, controlled at 350°C approximately 5 seconds while applying solder.

WAVE SOLDERING : Recommended Soldering Temperature: 260±5°C
 Duration of Solder Immersion: 5 ±1 seconds
 (PCB is 1.6mm in thickness)

SOLDERING : Vapor phase

Temperature Profile

Zone	Room temperature	Time (Sec)
Pre-heat (A)	150°C	Min 120s
Soak (B)	180°C~200°C	Min 150s
Peak (C)	200°C~235°C	Min 30s
Peak (D)	235°C~260°C	Min 40s
Peak (E)	260°C	Max 10s

